

Planning for our future

Draft Plan Site Submission Form

0%

Your Details

1. Name *

2. Your company name or organisation

3. Your clients name/company/organisation (where applicable)

4. Your e-mail address *

5. Your telephone number

6. Your address

[REDACTED]

7. Client's name (if applicable)

[REDACTED]

8. Site name

FRONT STREET, KLYMPSEFIELD

9. Site address

FRONT STREET
KLYMPSEFIELD.

Save and Continue Later

Next Page

From: _WEB_Planning
Sent: 20 January 2020 09:39
To: _WEB_Local Plan
Subject: FW: Local Plan Review
Attachments: IMG.pdf; IMG_0001.pdf; IMG_0002.pdf

Follow Up Flag: Follow up
Flag Status: Flagged

From: [REDACTED]
Sent: 20 January 2020 09:37
To: _WEB_Planning
Subject: Local Plan Review

Please find attached a Draft Plan Site Submission Form which puts forward a piece of land in Nympsfield all or part of which could be developed. The area to the south-west of the area coloured pink is in the same ownership but has a tree belt which would need to be retained so I have excluded it from the area for which consideration is requested. If you need any further information do please let me know.

Regards

[REDACTED]

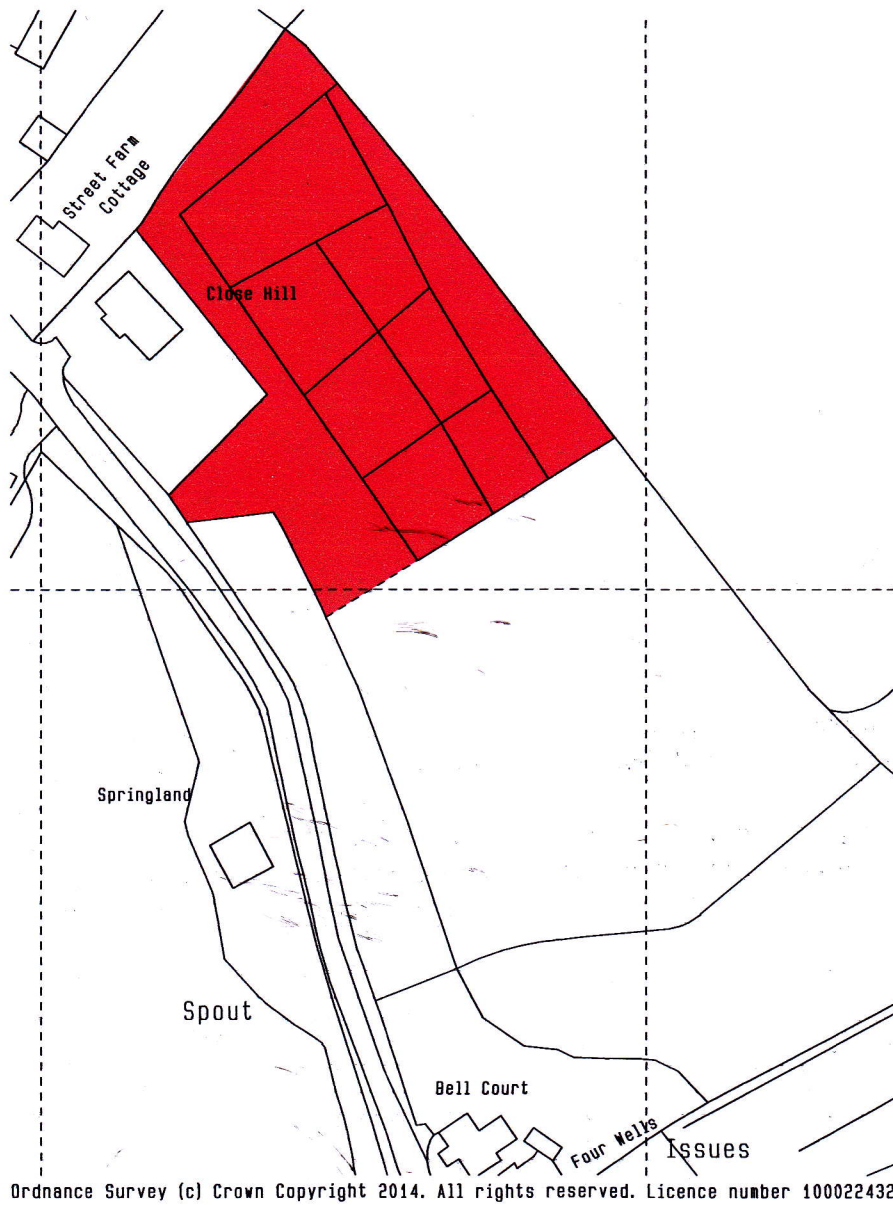

Reproduced with the permission
of the Controller H.M.S.O.
Crown Copyright Reserved.

<p>David Barnes Chartered Architect 7, High Street, Cam, DURSLEY, Gloucestershire GL11 5JZ</p>	<p>Land at Front Street, Nympsfield, Gloucestershire</p>
<p>Scale 1:1250 @ A4</p> <p>Date Oct 2014</p> <p>Drg No</p>	<p>Drg Title Site Location Plan</p>