

[REDACTED]

Dear Sir/Madam,

As an owner of property in Vicarage St since 1984 and a resident since 1993 I write to register my objection to the use of Washwell Fields as a preferred building site. In particular I object to the proposed access point in Lower Washwell Lane, increasing the traffic flow in Lower Washwell Lane and Vicarage St.

The objections of local residents as expressed on the enclosed PS 41 are well known to you and I fully concur with them. However I should like to emphasise the point of view of a pedestrian. As someone who daily walks up and down Vicarage St I am very aware of the dangers involved -----

- a) the speed of the traffic, commonly above 20mph
- b) the state of the pavement which is very uneven and of an odd camber, one chooses not to walk on it because of
- c) parked cars, now on both sides of the road.

The increased flow of traffic will inevitably increase the hazards.

I trust you will acknowledge these concerns, particularly for the young and the elderly, and take them into consideration.

Yours faithfully

[REDACTED] MBChB

Sent from [REDACTED]

[REDACTED]

Stroud District Council  
Received

14 JAN 2020

Development Services

# NEW HOUSES PLANNED FOR WASHWELL FIELDS (PS41)

WHAT WILL THIS  
MEAN FOR  
YOU?

Stroud District Council have chosen Washwell Fields as their preferred site for building up to 20 additional houses in Painswick. You can see the **map overleaf** or find full details at:

[https://www.stroud.gov.uk/info/Draft\\_Plan\\_2019.pdf](https://www.stroud.gov.uk/info/Draft_Plan_2019.pdf) (scroll down to pages 145/146)

Access has been proposed via Lower Washwell Lane. You might not know where Washwell Fields is or even care, but if you live in Lower Washwell Lane, Vicarage Street or the centre of Painswick then this proposal may well have an impact on you for these reasons:

## **Increased traffic usage along Lower Washwell Lane**

20 additional houses will likely see increasing traffic pressure from around 40 additional resident cars, as well as related trade and service vehicles. That's not going to go unnoticed!

## **Increased congestion at the junction with the A46**

This blind junction onto the A46 is already difficult to negotiate particularly during the rush hours. With more vehicles using this junction, traffic will increasingly back up in both Lower Washwell Lane and Pullen's Road.

## **Increased traffic flow along Vicarage Street and through the village centre**

When there is congestion or difficulty accessing the A46 from Lower Washwell Lane, the alternative will be via Vicarage Street and the village centre. The traffic choke points here are already well recognised by residents and our Parish and District Councils. This proposal will only make matters worse.

## **Increased risk of accident at the junction with the A46**

It is quite surprising that there hasn't been a serious accident here to date, but if you use this junction you know it is potentially dangerous, particularly at rush hour and in the dark. Cars accelerate rapidly out of the traffic lights and there is often confusion over right of way with cars joining from Pullen's Road. Increased traffic will just make it more dangerous.

## **Increased risk of accident to pedestrians, children, horses and pets**

Washwell Lane and Vicarage Street are well used by walkers, joggers, riders and children on their way to school or The Rec. The roads are predominantly single track and many houses in Vicarage Street open directly onto the road. Will more cars and vans improve safety?

We all recognise the need for new housing, but access to this site via Lower Washwell Lane has not been thought through. More suitable access to a development of this scale might be possible directly off the A46, even if this would create different challenges.

**NOW  
IS THE  
TIME TO  
SPEAK OUT!**

**You have until  
22<sup>nd</sup> JANUARY 2020  
to register your comments  
Email: [local.plan@stroud.gov.uk](mailto:local.plan@stroud.gov.uk)**

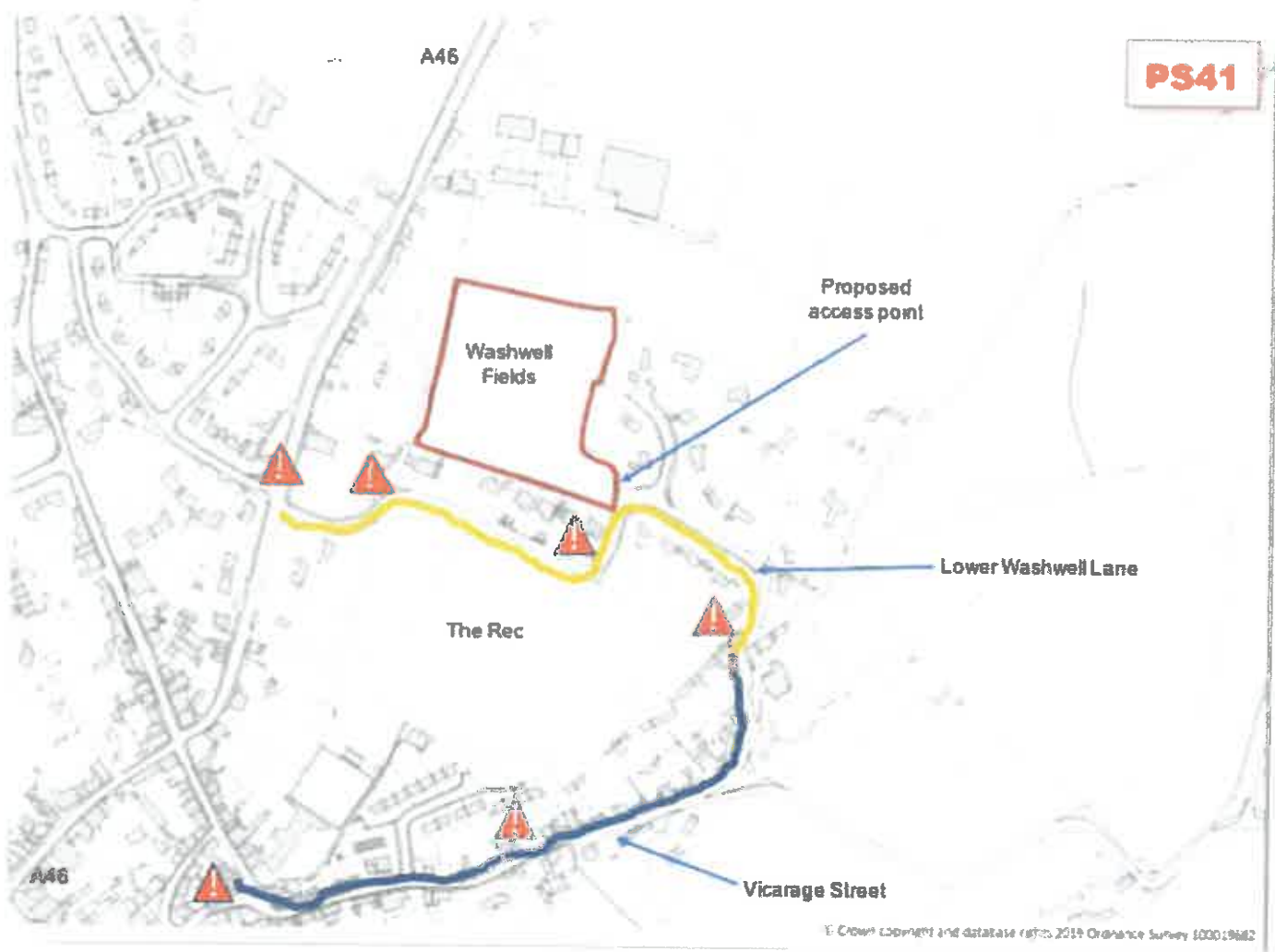

Basic map as presented in Stroud District Council Draft Plan 2019

Dear Resident,

We are a growing group of concerned Painswickians **and we do not want to see our lanes turned into a worse rat-run than they already are.** We need your support and we need it now.

If this proposal is accepted into the Plan then it will be hard to remove. There is opportunity now for our Parish Council and District Council to think through the implications of this proposal and put safety and traffic congestion at the top of their agenda.

**Please support us by:**

- 1 Registering your concerns on traffic and safety with the Local Plan**
- 2. Signing our petition, which we will be bringing round in January**

If you would like to help us or receive information then please contact one of us as follows:



**DEADLINE 22<sup>nd</sup> JANUARY**

**NOW IS THE TIME TO SPEAK OUT!**